

## Scheda Tecnica Pergola Pure

pure

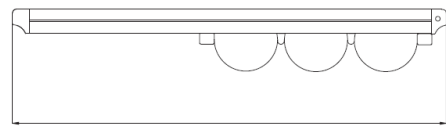
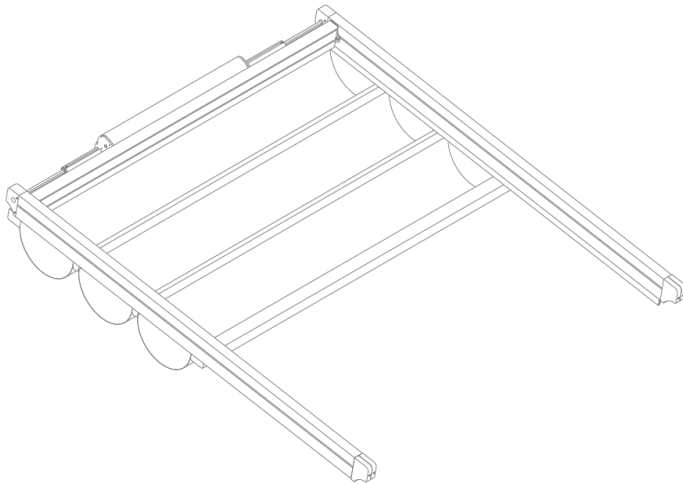

(max. 1000 cm)  
sporgenza

**Un modulo** 200 cm > 450 cm

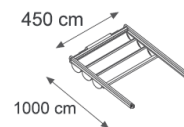
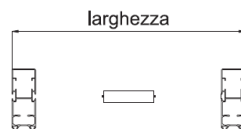

**Due moduli** 450 cm > 900 cm  
sistema a telo unico

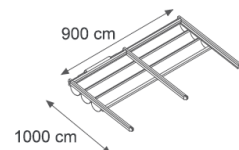
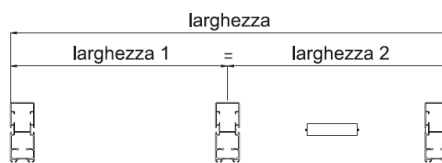

**Tre moduli** 900 cm > 1300 cm  
sistema a telo unico

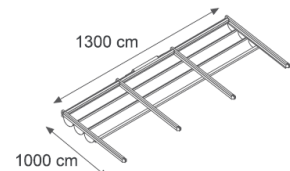
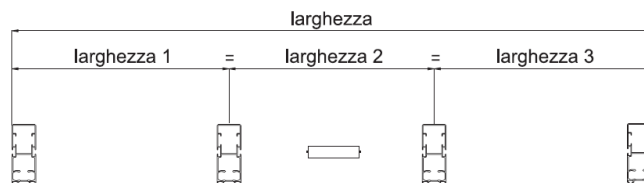

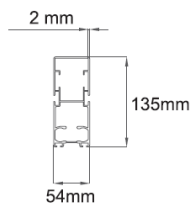
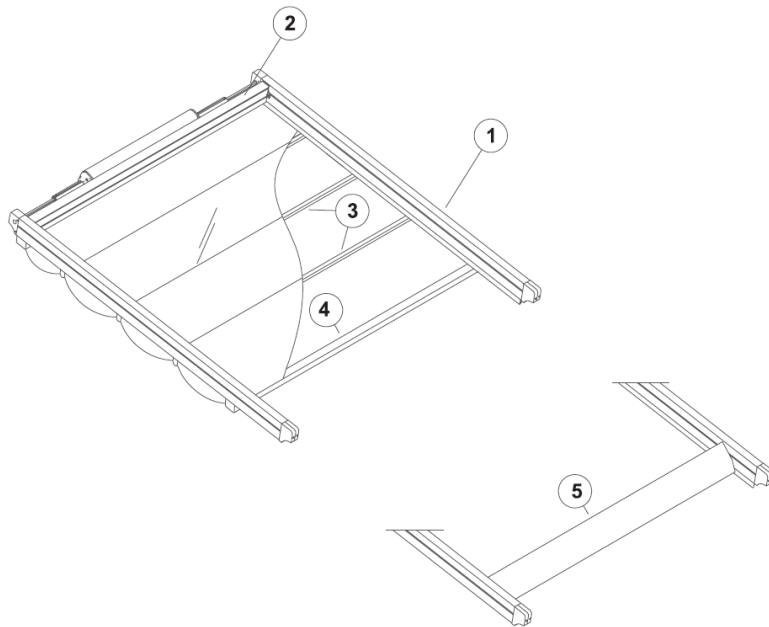

① Binario

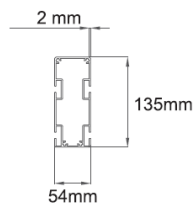

② Supporto motore

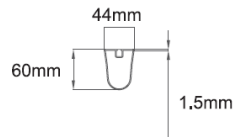

③ Reggi-telo

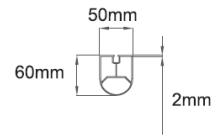

③ Reggi-telo  
(HDD LUX)

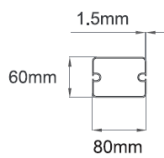

④ terminale

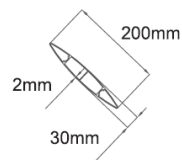

⑤ Alettone Louvre

pure

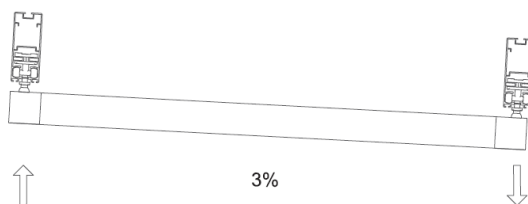
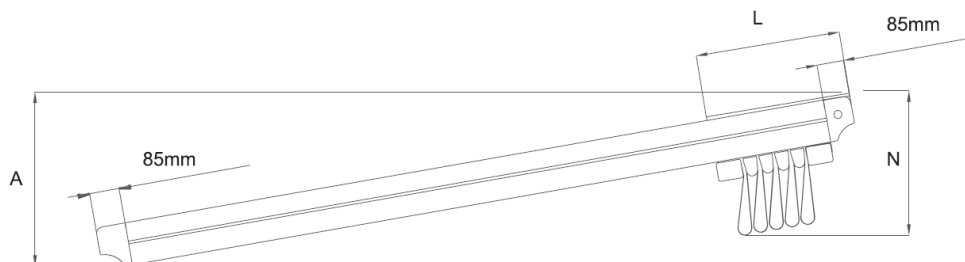

Piastra di supporto a "L"



Piastra di supporto "W160"



Piastra di supporto "W200"

pure



Piastra di supporto standard



Binario

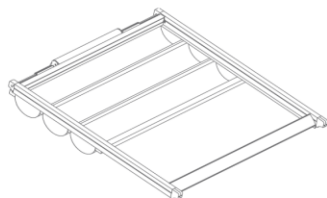
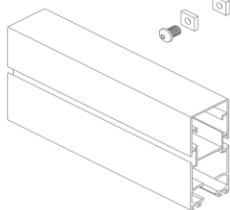

Alettone Louvre

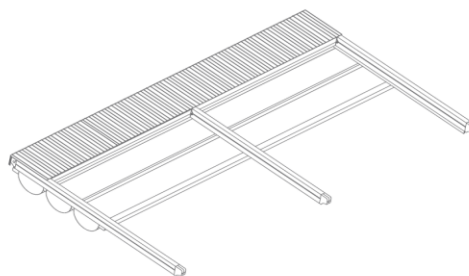

Tettuccio protettivo